

WINCHESTER (SHERMAN CLAY PLAZA)

SANTA CLARA, CALIFORNIA

DRAWING PREPARED BY:
OSBORN AND VANE ARCHITECTS INC
04057 \ 5 MARCH 2015

SITE PLAN

SCALE 1" = 20'

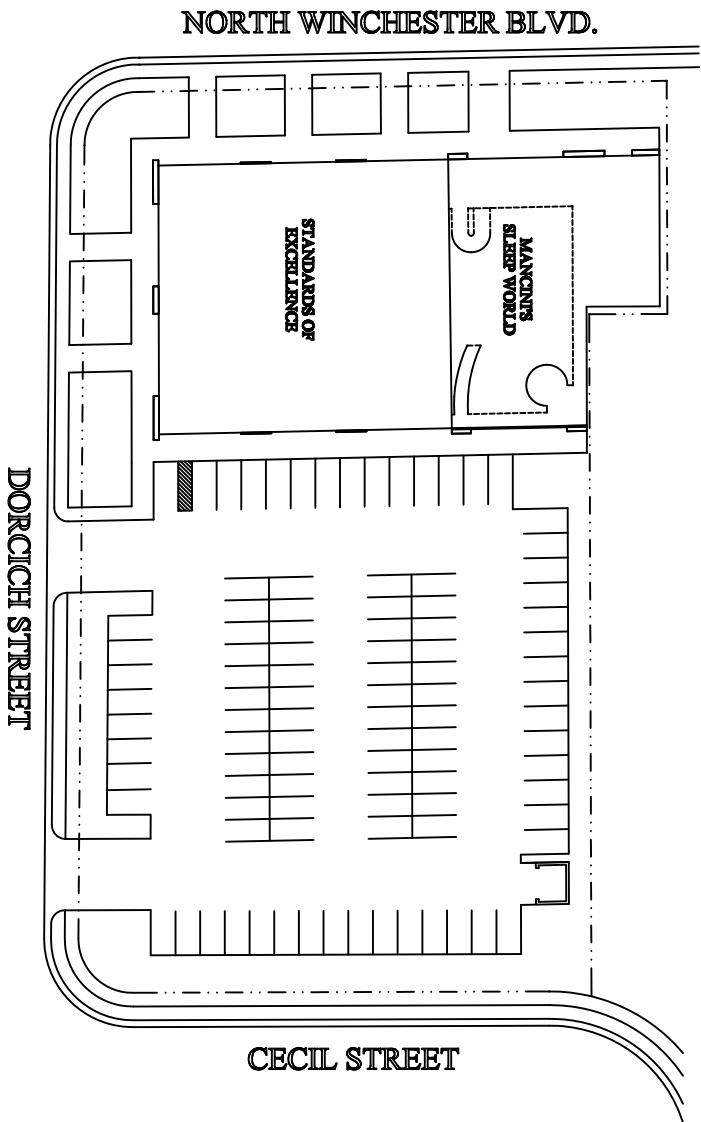

S.C. MANAGEMENT COMPANY
P.O. BOX 690024
HOUSTON, TEXAS 77268
(281) 537-9066

NOTES:

1. PLAN DIMENSIONS AND STORE FRONTAGES LISTED ARE APPROXIMATE ONLY. AREAS SHOWN ARE ACTUAL PRESENT LEASABLE AREAS.
2. PARKING SPACE LOCATION AND ACTUAL CAR COUNT IS REASONABLY ACCURATE BASED ON GIVEN DATA AND AN ON-SITE SURVEY. THESE SPACES ARE SUBJECT TO CHANGES AND CURRENT EXISTING CONDITIONS MAY NOT BE REFLECTED ON THIS DRAWING.
3. MAJOR OR ANCHOR TENANTS EXIST AS OF DATE OF DRAWING. HOWEVER, THESE SPACES AND THEIR TENANTS ARE SUBJECT TO CHANGE.

STATISTICS

SPACE	AREA	FRONTAGE
MANCINI'S SLEEP WORLD	9,498 S.F.	126.0'
STANDARDS OF EXCELLENCE	10,245 S.F.	317.0'
TOTAL LEASE AREA:	19,743 S.F.	
TOTAL LAND AREA:	63,429 S.F.	
BLDG./LAND RATIO:	31.1 %	
TOTAL PARKING:	100 CARS	
PARKING RATIO:	5.07 cars/1000	